

12" Fixed Retainer Sign Frame x 24' 6"
With LED Baffle - **NEW!**
24-63-231

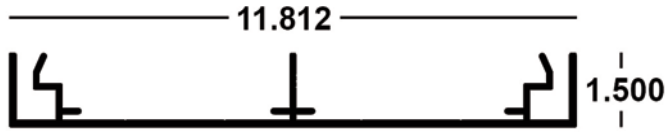

10" Fixed Retainer Sign Frame x 24' 6"
With LED Baffle - **NEW!**
24-63-221

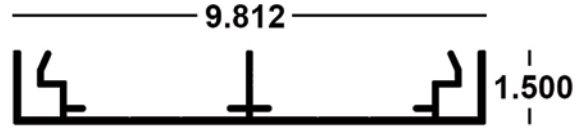

12" Sign Frame x 24' 6" w/o Retainer
With LED Baffle - **NEW!**
24-63-239

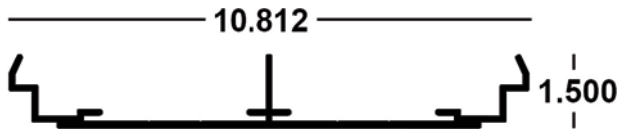

10" Sign Frame x 24' 6" w/o Retainer
With LED Baffle - **NEW!**
24-63-226

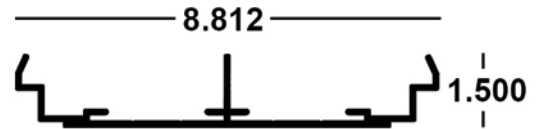

Corner Keys for 12" Baffle Sign Frame - NEW!

Includes Right and Left Corner Key per Set;
Each Sign needs 2 sets; 3 Variations Available
24-63-294 (Retainer to Retainer)
24-63-295 (W/O Retainer to W/O Retainer)
24-63-296 (Without Retainer to Retainer)

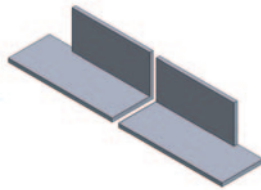

Corner Keys for 10" Baffle Sign Frame - NEW!

Includes Right and Left Corner Key per Set;
Each Sign needs 2 sets; 3 Variations Available
24-63-291 (Retainer to Retainer)
24-63-292 (W/O Retainer to W/O Retainer)
24-63-293 (Without Retainer to Retainer)

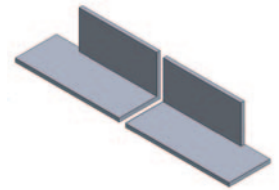

FEATURES & BENEFITS

- Quicker LED Installations
Allows for LED Stick install and ACM installations
- Significant Labor Savings
- Easier Fabrication Compared to Non Baffle
- Reduced material
- Easy Installation
- Interchangeable with previous generation of EMS Sign Frames

Corner Keys Assembly for Baffle Sign Frames

Each Corner Key kit includes
Right and Left Corner Keys per Set
Each Sign needs 2 sets

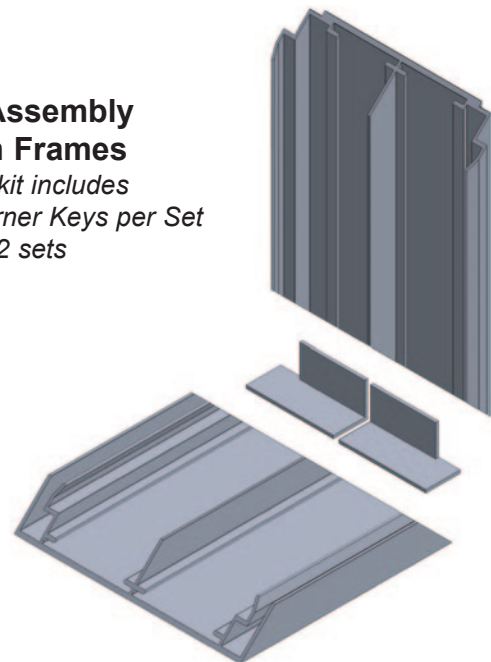

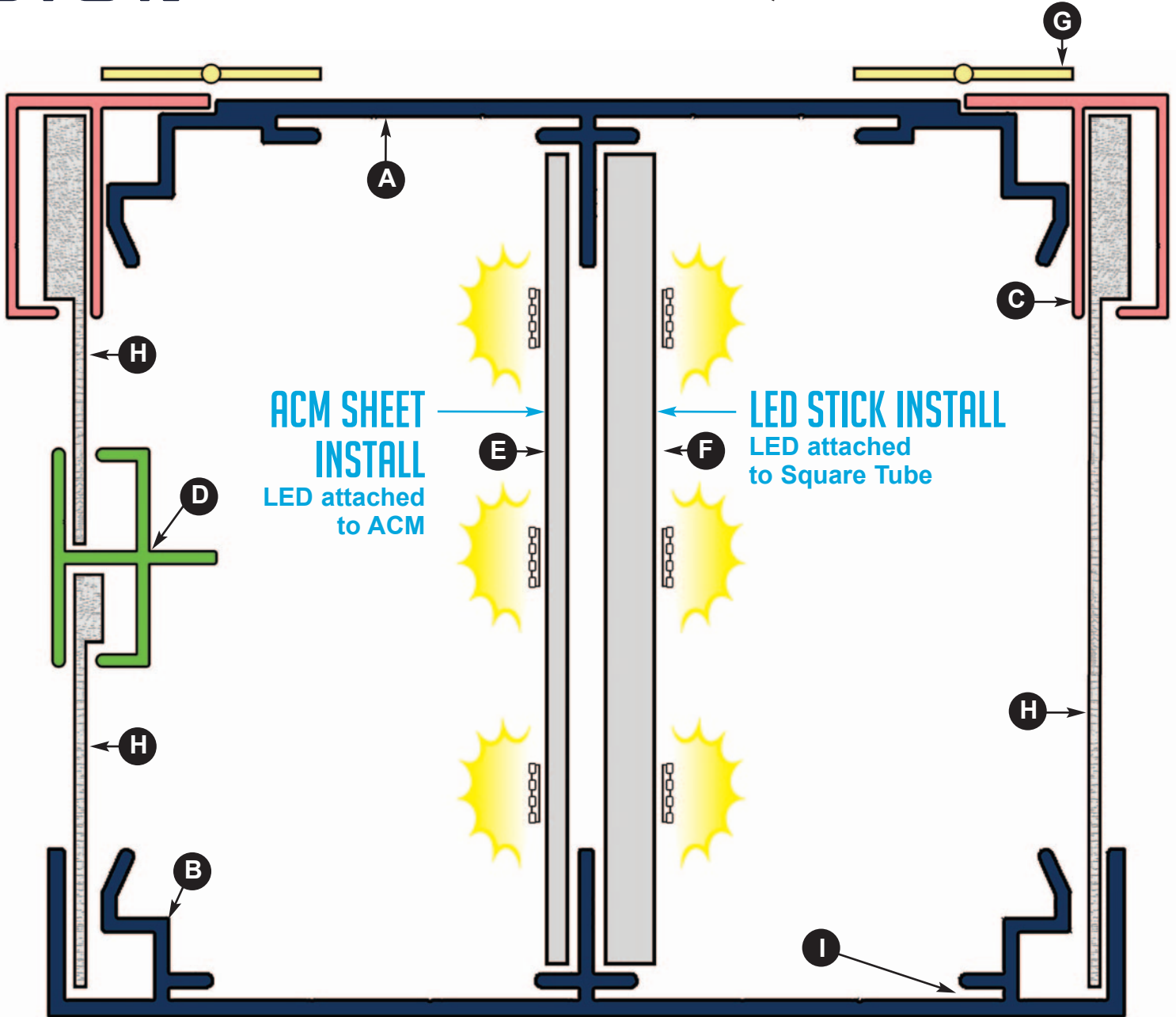

SIGN FRAME SCHEMATIC CABINET CUTAWAY

- A. Sign Frame with LED Baffle without Retainer
- B. Sign Frame with LED Baffle with Retainer
- C. F-Retainer
- D. Divider Bars (optional; Multiple Options Available)
- E. ACM Sheet (Used to mount LED)
- F. Square Tube (Used to stick mount LED)
- G. Piano Hinge (optional)
- H. Sign Face
- I. Corner Key Slots (see reverse side for available options)

ALSO AVAILABLE:

Traditional Sign Frames, Flex Face, Raceways, Channel Letter Coil, ACM, Painted Sheet