

# Rectangular Aluminum Bar - 6061-T6511 x 12'



<u>Stock Code</u>	<u>Size in Inches (E x M)</u>	<u>Approx. Wt/Lin ft.</u>	<u>Stock Code</u>	<u>Size in Inches (E x M)</u>	<u>Approx. Wt/Lin ft.</u>
<u>10-61-200</u>	1/8 x 1/2	0.074	10-61-445	3/8 x 6	2.645
MILL ORDER <u>52-61-4303</u>	1/8 x 5/8	0.092	<u>10-61-446</u>	3/8 x 7	3.087
<u>10-61-201</u>	1/8 x 3/4	0.110	10-61-450	3/8 x 8	3.528
10-61-215	1/8 x 1	0.150	10-61-455	3/8 x 10	4.410
<u>10-61-220</u>	1/8 x 1-1/4	0.188	33-61-105	3/8 x 12	5.292
10-61-225	1/8 x 1-1/2	0.225	<u>10-61-828</u>	1/2 x 3/4	0.441
10-61-230	1/8 x 2	0.300	10-61-475	1/2 x 1	0.600
10-61-231 (TX)	1/8 x 2-1/2	0.375	MILL ORDER <u>10-61-477 (NC)</u>	1/2 x 1-1/4	0.734
MILL ORDER	3/16 x 3/4	0.169	10-61-480	1/2 x 1-1/2	0.900
10-61-265	3/16 x 1	0.226	10-61-485	1/2 x 2	1.200
MILL ORDER <u>10-61-270 (TX)</u>	3/16 x 1-1/4	0.275	<u>10-61-487</u>	1/2 x 2-1/4	1.323
10-61-275	3/16 x 1-1/2	0.338	10-61-486	1/2 x 2-1/2	1.500
10-61-285	3/16 x 2	0.451	10-61-490	1/2 x 3	1.800
MILL ORDER <u>10-61-286 (NC)</u>	3/16 x 2-1/2	0.561	10-61-500	1/2 x 4	2.400
<u>10-61-615</u>	3/16 x 4	0.884	10-61-501	1/2 x 5	2.940
10-61-324	1/4 x 1/2	0.147	10-61-505	1/2 x 6	3.600
<u>10-61-300</u>	1/4 x 3/4	0.221	<u>52-61-3400</u>	1/2 x 7	4.116
10-61-325	1/4 x 1	0.300	10-61-511	1/2 x 8	4.704
10-61-330	1/4 x 1-1/4	0.376	MILL ORDER <u>52-61-2037 (NC)</u>	1/2 x 9	5.292
10-61-335	1/4 x 1-1/2	0.450	10-61-515	1/2 x 10	5.880
MILL ORDER <u>10-61-800 (NC)</u>	1/4 x 1-3/4	0.524	33-61-110	1/2 x 12	7.056
10-61-340*	1/4 x 2	0.600	<u>33-61-112</u>	1/2 x 14	8.470
10-61-345	1/4 x 2-1/2	0.735	<u>10-61-516</u>	5/8 x 2	1.470
10-61-350*	1/4 x 3	0.900	<u>10-61-518</u>	5/8 x 3	2.205
<u>10-61-353</u>	1/4 x 3-1/2	1.050	<u>10-61-517</u>	5/8 x 4	2.940
10-61-355*	1/4 x 4	1.200	<u>52-61-2658</u>	5/8 x 6	4.500
10-61-360	1/4 x 5	1.500	10-61-545	3/4 x 1	0.881
10-61-365	1/4 x 6	1.800	<u>10-61-725</u>	3/4 x 1-1/4	1.102
<u>10-61-366</u>	1/4 x 7	2.058	10-61-550	3/4 x 1-1/2	1.350
10-61-370	1/4 x 8	2.352	<u>10-61-551</u>	3/4 x 1-3/4	1.544
10-61-375	1/4 x 10	2.940	10-61-560	3/4 x 2	1.800
33-61-100	1/4 x 12	3.528	<u>10-61-561</u>	3/4 x 2-1/4	1.985
<u>10-61-380</u>	5/16 x 3	1.101	<u>10-61-562</u>	3/4 x 2-1/2	2.205
<u>10-61-414</u>	3/8 x 1/2	0.221	10-61-565	3/4 x 3	2.700
10-61-415	3/8 x 1	0.450	<u>10-61-567</u>	3/4 x 3-1/2	3.087
10-61-416	3/8 x 1-1/4	0.563	10-61-570	3/4 x 4	3.528
10-61-420	3/8 x 1-1/2	0.675	<u>10-61-571</u>	3/4 x 5	4.500
10-61-426	3/8 x 2	0.900	10-61-575	3/4 x 6	5.400
10-61-417	3/8 x 2-1/2	1.126	10-61-576	3/4 x 8	7.056
10-61-435	3/8 x 3	1.350	MILL ORDER <u>EMS505039</u>	3/4 x 10	7.200
10-61-440*	3/8 x 4	1.800	33-61-120	3/4 x 12	10.584
<u>10-61-442</u>	3/8 x 4-1/2	1.985	<u>10-61-763</u>	1 x 1-1/4	1.486
10-61-443*	3/8 x 5	2.205			

Items marked as MILL ORDER are non stock but available. Product codes listed on MILL ORDER items are for die reference only. Customer must specify length, alloy & temper.

\*Additional Rectangular Bar in BDA Finish (6463 Alloy) Available on Marine 04

Additional Sizes on next page (Standards p02) →

## Standards 01



### EMS FL

1-800-432-2204  
(561) 588-4780 - fax

### EMS NC

1-800-343-8154  
(704) 391-2267 - fax

### EMS TX

1-800-996-6061  
(281) 656-2297 - fax

### EMS MO

1-888-822-6061  
(314) 344-3349 - fax

**Eastern Metal Supply**

Quality Shapes In Aluminum

Additional Locations: West Palm Beach & Lakeland, FL; Newark, DE; Akron, OH, Van Buren, AR; Atlanta, GA and Dallas, TX

website: [www.EasternMetal.com](http://www.EasternMetal.com)

e-mail: [info@EasternMetal.com](mailto:info@EasternMetal.com)

version: 09/02/20

# Rectangular Aluminum Bar - 6061-T6511 x 12' (con't)



Stock Code	Size in Inches (E x M)	Approx. Wt/Lin ft.	Stock Code	Size in Inches (E x M)	Approx. Wt/Lin ft.
10-61-620	1 x 1-1/2	1.800	10-61-631	1-1/4 x 2	2.940
10-61-621	1 x 1-3/4	2.058	10-61-706	1-1/4 x 6	8.820
10-61-600	1 x 2	2.350	10-61-690	1-1/2 x 1-3/4	3.087
10-61-604	1 x 2-1/4	2.646	10-61-701	1-1/2 x 3	5.292
10-61-603	1 x 2-1/2	2.940	10-61-704	1-1/2 x 4	7.056
10-61-601	1 x 3	3.528	MILL ORDER	1-1/2 x 6 EMS550646	10.672
10-61-606	1 x 3-1/2	4.155	MILL ORDER	1-1/2 x 12 EMS505068	21.168
10-61-602	1 x 4	4.800	52-61-1161	2 x 3	7.056
10-61-610	1 x 6	7.200	10-61-700	2 x 4	9.408
10-61-611	1 x 8	9.600	10-61-702	2 x 6	14.100
10-61-612	1 x 10	11.760	MILL ORDER	3 x 5 52-61-2459	17.640
33-61-125	1 x 12	14.400	MILL ORDER	3 x 6 EMS550649	21.331
10-61-630	1-1/4 x 1-1/2	2.205	MILL ORDER	4 x 6 EMS550651	28.448
10-61-640	1-1/4 x 1-3/4	2.597			

# Rectangular Aluminum Bar - 6063-T52 x 20'

Stock Code	Size in Inches (E x M)	Approx. Wt/Lin ft.	Stock Code	Size in Inches (E x M)	Approx. Wt/Lin ft.
10-63-100	.085 x 2" x 12'1"	0.198	MILL ORDER	1/4 x 2-1/2 52-63-4171	0.734
10-63-200	1/8 x 1/2	0.078	10-63-340*	1/4 x 3	0.900
MILL ORDER	1/8 x 5/8 52-63-12436	0.092	10-63-345*	1/4 x 4	1.200
10-63-210	1/8 x 3/4	0.113	10-63-350	1/4 x 6	1.800
10-63-215	1/8 x 1	0.15	10-63-355	3/8 x 1/2	0.225
10-63-220	1/8 x 1-1/4	0.188	10-63-357	3/8 x 5/8	0.281
10-63-225	1/8 x 1-1/2	0.225	10-63-365	3/8 x 3/4	0.337
10-63-230	1/8 x 1-3/4	0.263	10-63-370	3/8 x 1	0.450
10-63-235	1/8 x 2	0.300	10-63-375	3/8 x 1-1/4	0.563
10-63-240	1/8 x 3	0.450	10-63-380	3/8 x 1-1/2	0.675
10-63-245*	1/8 x 4	0.600	10-63-385	3/8 x 2	0.900
10-63-250	1/8 x 6	0.900	10-63-386	3/8 x 3	1.350
50-06-127	1/8 x 12 x 10'	1.833	10-63-390*	3/8 x 4	1.800
	Gusset Plate (5052 H38 Alodine)		10-63-400	1/2 x 3/4	0.450
10-63-255	3/16 x 1/2	0.113	10-63-405	1/2 x 1	0.600
10-63-260	3/16 x 3/4	0.169	MILL ORDER	1/2 x 1-1/4 52-63-1627	0.734
10-63-265	3/16 x 1	0.226	10-63-410	1/2 x 1-1/2	0.900
10-63-270	3/16 x 1-1/4	0.283	10-63-415	1/2 x 2	1.200
10-63-275	3/16 x 1-1/2	0.338	10-63-420	1/2 x 2-1/2	1.500
10-63-280	3/16 x 2	0.451	10-63-425	1/2 x 3	1.800
MILL ORDER	3/16 x 2-1/2 52-63-12417	0.551	MILL ORDER	1/2 x 4 10-63-431 (NC)	2.400
10-63-285	3/16 x 3	0.677	MILL ORDER	3/4 x 1-1/2 10-63-540 (NC)	1.350
52-63-12927	3/16 x 3-1/2 x 8'	0.790	MILL ORDER	3/4 x 2 10-63-501 (NC)	1.800
10-63-290	3/16 x 4	0.902	MILL ORDER	1 x 1-1/2 10-63-440 (NC)	1.500
10-63-300	3/16 x 12 (12')	2.707	MILL ORDER	1 x 2 52-63-035	2.350
10-63-324	1/4 x 1/2 (12')	0.150			
10-63-305	1/4 x 1/2	0.150			
10-63-308	1/4 x 5/8	0.188			
10-63-310	1/4 x 3/4	0.226			
10-63-315	1/4 x 1	0.300			
10-63-320	1/4 x 1-1/4	0.376			
10-63-325	1/4 x 1-1/2	0.450			
MILL ORDER	1/4 x 1-3/4	0.524			
10-63-335*	1/4 x 2	0.600			

## Aluminum Rectangular Bar Grating

Special Order Various Sizes Available Upon Request



\*Additional Rectangular Bar in BDA Finish (6463 Alloy)  
Available on Marine 04

Items marked as MILL ORDER are non stock but available.  
Product codes listed on MILL ORDER items are for die reference only. Customer must specify length, alloy & temper.

Standards 02



**EMS FL**

1-800-432-2204

(561) 588-4780 - fax

**EMS NC**

1-800-343-8154

(704) 391-2267 - fax

**EMS TX**

1-800-996-6061

(281) 656-2297 - fax

**EMS MO**

1-888-822-6061

(314) 344-3349 - fax

**Eastern Metal Supply**

Quality Shapes In Aluminum

Additional Locations: West Palm Beach & Lakeland, FL; Newark, DE; Akron, OH, Van Buren, AR; Atlanta, GA and Dallas, TX

website: [www.EasternMetal.com](http://www.EasternMetal.com)

e-mail: [info@EasternMetal.com](mailto:info@EasternMetal.com)

version: 09/02/20

## Square Aluminum Bar - 6061-T6511 x 12'

<u>Stock Code</u>	<u>Size in Inches</u>	<u>Approx. Wt/Lin ft.</u>
MILL ORDER <i>52-61-1636</i>	1/4	0.074
MILL ORDER <i>15-61-100</i>	3/8	0.169
15-61-200	1/2	0.300
15-61-201 (NC)	5/8	0.459
15-61-205	3/4	0.674
15-61-210	1	1.200
15-61-215	1-1/4	1.888
15-61-225	1-1/2	2.745
<u>15-61-226</u>	1-3/4	3.602
15-61-220	2	4.699
<u>15-61-221</u>	2-1/4	5.947
<u>15-61-222</u>	2-1/2	7.350
<u>15-61-223</u>	3	10.584
MILL ORDER <i>15-61-307 (NC)</i>	3-1/4	12.409
MILL ORDER <i>15-61-250 (NC)</i>	3-1/2	14.396
MILL ORDER <i>15-61-260 (NC)</i>	4	18.797
MILL ORDER <i>EMS550607</i>	5	29.600
MILL ORDER <i>EMS550600</i>	6	42.647

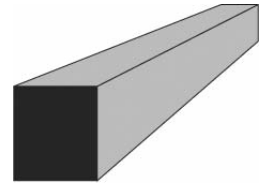

## Square Aluminum Bar - 6063-T52 x 20'

<u>Stock Code</u>	<u>Size in Inches</u>	<u>Approx. Wt/Lin ft.</u>
MILL ORDER <i>15-63-200 (NC)</i>	1/4	0.073
15-63-205	3/8	0.169
15-63-210	1/2	0.300
15-63-215	5/8	0.468
15-63-220	3/4	0.674
15-63-225	1	1.200
MILL ORDER <i>15-63-230 (NC)</i>	1-1/4	1.875
MILL ORDER <i>52-63-13074</i>	1-1/2	2.745

*Items marked as MILL ORDER are non stock but available.  
Product codes listed on MILL ORDER items are for die reference only.  
Customer must specify length, alloy & temper.*

Standards 03



**Eastern Metal Supply**

Quality Shapes In Aluminum

### EMS FL

1-800-432-2204

(561) 588-4780 - fax

### EMS NC

1-800-343-8154

(704) 391-2267 - fax

### EMS TX

1-800-996-6061

(281) 656-2297 - fax

### EMS MO

1-888-822-6061

(314) 344-3349 - fax

Additional Locations: West Palm Beach & Lakeland, FL; Newark, DE and Birmingham, AL

website: [www.EasternMetal.com](http://www.EasternMetal.com)

e-mail: [info@EasternMetal.com](mailto:info@EasternMetal.com)

version: 08/25/16

# Round Aluminum Rod - 6061-T6511 x 12'

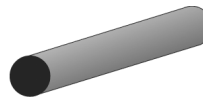

<u>Stock Code</u>	<u>Size in Inches</u>	<u>Approx. Wt/Lin ft.</u>	<u>Stock Code</u>	<u>Size in Inches</u>	<u>Approx. Wt/Lin ft.</u>
MILL ORDER <i>14-61-543 (NC)</i>	1/8	0.015	MILL ORDER <i>52-61-3305</i>	1-13/16	3.042
MILL ORDER <i>14-61-405 (NC)</i>	3/16	0.032	<u>14-61-453</u>	1-7/8	3.247
MILL ORDER	7/32	0.044	14-61-455	2	3.691
14-61-410	1/4	0.058	MILL ORDER	2-1/8	4.166
MILL ORDER <i>14-61-517 (NC)</i>	5/16	0.090	<u>14-61-454</u>	2-1/4	4.676
14-61-415	3/8	0.133	14-61-457	2-3/8	5.210
14-61-419	7/16	0.178	14-61-456	2-1/2	5.733
14-61-420	1/2	0.235	<u>14-61-458</u>	2-5/8	6.364
MILL ORDER <i>14-61-426</i>	9/16	0.292	<u>14-61-459</u>	2-3/4	6.985
14-61-425	5/8	0.368	14-61-460	3	8.304
14-61-430 (DOT-61-180)	3/4	0.530	<u>14-61-461</u>	3-1/4	9.756
<u>14-61-431</u>	7/8	0.707	<u>14-61-462</u>	3-1/2	11.314
14-61-435	1	0.942	MILL ORDER	3-5/8	12.140
<u>14-61-436</u>	1-1/16	1.042	<u>14-61-464</u>	3-3/4	12.989
MILL ORDER <i>14-61-542 (NC)</i>	1-1/8	1.169	14-61-470	4	14.763
14-61-440	1-1/4	1.472	<u>14-61-472</u>	4-1/2	18.703
<u>14-61-442</u>	1-5/16	1.590	<u>14-61-480</u>	5	23.091
14-61-441	1-3/8	1.745	MILL ORDER <i>14-61-508 (NC)</i>	5-1/2	27.998
MILL ORDER <i>52-61-3717</i>	1-7/16	1.925	14-61-485	6	33.250
14-61-445	1-1/2	2.110	MILL ORDER <i>14-61-535 (NC)</i>	6-1/2	38.988
<u>14-61-447</u>	1-5/8	2.439	MILL ORDER <i>14-61-495 (NC)</i>	7	45.214
14-61-450	1-3/4	2.826	MILL ORDER <i>14-61-206 (TX)</i>	7-1/2	51.961
			MILL ORDER <i>52-61-1749</i>	8	59.091

# Round Aluminum Rod - 6063-T52 x 20'

<u>Stock Code</u>	<u>Size in Inches</u>	<u>Approx. Wt/Lin ft.</u>
14-63-205	1/4 x 12'	0.059
14-63-211	3/8	0.133
14-63-215	1/2	0.235
14-63-220	5/8	0.368
14-63-225	3/4	0.530
14-DOT-225* (6063-T52)	3/4 x 20'	0.530
MILL ORDER <i>14-63-226</i>	7/8	0.722
14-63-230	1	0.942
14-DOT-230* (6063-T52)	1 x 20'	0.942
MILL ORDER	1-1/4	1.443
MILL ORDER <i>14-63-240</i>	1-1/2	2.077
MILL ORDER <i>14-63-310 (NC)</i>	3	8.484

\*6063-T52 Full Certs Available

Items marked as MILL ORDER are non stock but available.  
 Product codes listed on MILL ORDER items are for die reference only.  
 Customer must specify length, alloy & temper.

Standards 04



**Eastern Metal Supply**  
 Quality Shapes In Aluminum

### EMS FL

1-800-432-2204  
 (561) 588-4780 - fax

### EMS NC

1-800-343-8154  
 (704) 391-2267 - fax

### EMS TX

1-800-996-6061  
 (281) 656-2297 - fax

### EMS MO

1-888-822-6061  
 (314) 344-3349 - fax

Additional Locations: West Palm Beach & Lakeland, FL; Newark, DE; Akron, OH, Van Buren, AR; Atlanta, GA and Dallas, TX

website: [www.EasternMetal.com](http://www.EasternMetal.com)

e-mail: [info@EasternMetal.com](mailto:info@EasternMetal.com)

version: 11/25/19